

FR ALUM

FR 0 / FR 1 / FR 2 / FR 3

The Justor FR retaining brake eliminates door slams caused by a bad usage of the door or self-closing devices being previously installed. It operates in the last 10° ensuring the total closing of the door. Possibility to adjust the closing speed in between 1 and 10 seconds. Different models according to the strength. Fixed or adjustable closing speed (G models).

Outside materials

- cylindrical body: anodized aluminum.
- other external components: painted steel.
- hook: steel (painted)
- pins: steel (galvanized)
- wheel: synthetic rubber

Inside materials

- hydraulic oil
- inner spring: special

Performance

- mechanism: hydraulic system
- closing system: possibility of fixed or adjustable closing speed (G models)

Proper installation

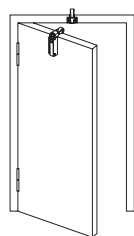

Easy speed adjustment (G models)

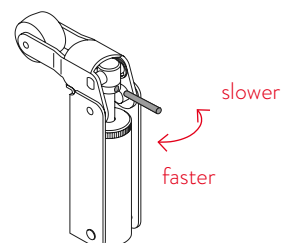

FR 0 (G) FR 1 (G)

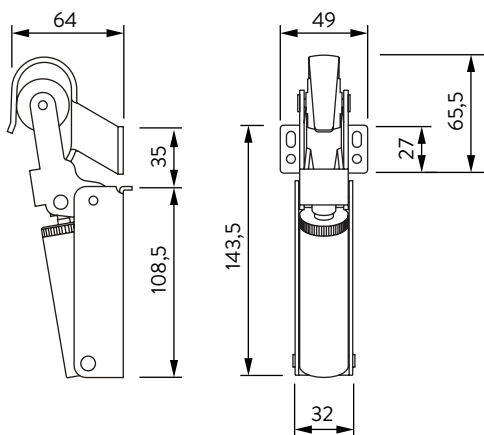
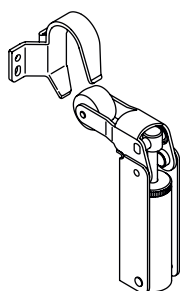

| | FR 0 FR 0 G | FR 1 FR 1 G |
|------------------|----------------|----------------|
| Strength (N) | 30 | 60 |
| Door width (cm) | 75 | 85 |
| Door weight (kg) | 15 | 40 |

FR 2 (G) FR 3 (G)

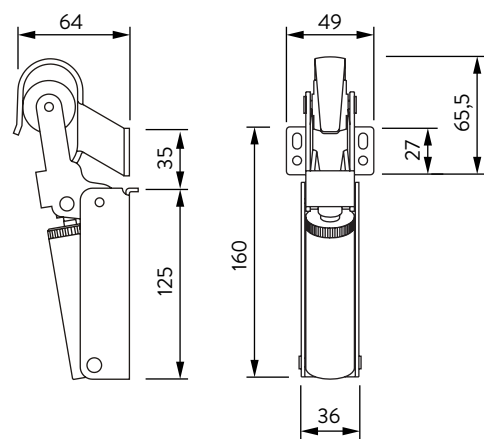
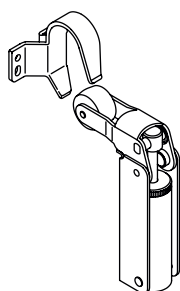

| | FR 2 FR 2 G | FR 3 FR 3 G |
|------------------|----------------|----------------|
| Strength (N) | 80 | 115 |
| Door width (cm) | 110 | 125 |
| Door weight (kg) | 80 | 100 |