

# PM ALUM

## PM 120

Spring paumelle for wooden doors. Makes installation easier, not necessary to unscrew the hinges if removing the door is necessary at any given time. Available in left and right opening models according to installation.

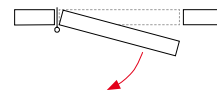

### Outside materials

- blade: anodized aluminum
- adjustable cap: zamac
- washers: polyamide

### Inside materials

- inner axle: stainless steel AISI 304
- inner spring: stainless steel blades set with protective grease

### Performance

- application: suitable for indoor/ outdoor installation
- automatic return: yes
- adjustable return power: yes
- maximum door opening: 180°
- working cycles: up to 500.000

### Proper installation of 2 and 3 hinges

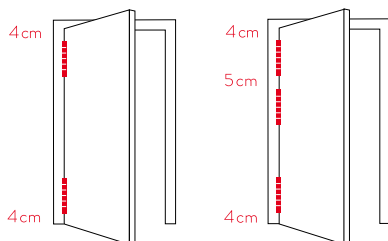

### Tension

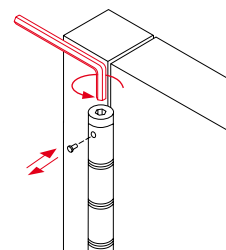

3-points adjusting cap

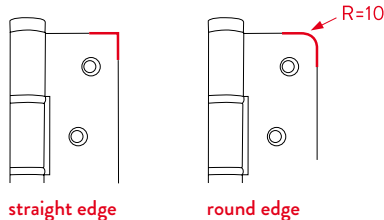

straight edge

round edge

## PM 120

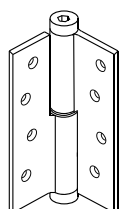

120

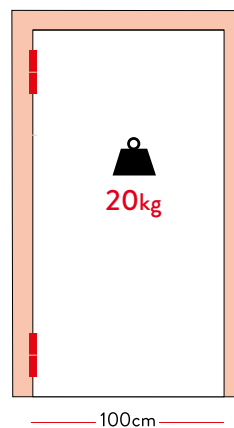
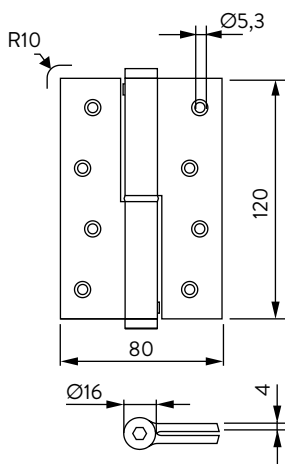
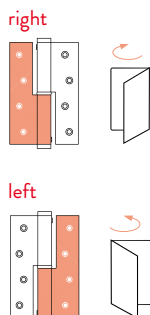

20kg

100cm

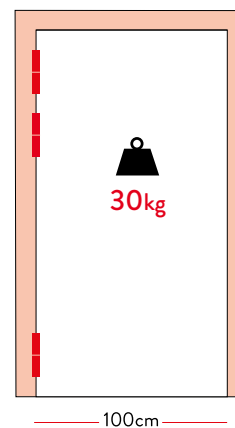

30kg

100cm