

MZ ALUM PLAST

MZ AL / MZ PL

Screen door hinge. Ensures automatic closure of this type of auxiliary door, preventing any unwanted insects. Made of aluminum for wooden doors and high-resistance plastic for aluminum doors.

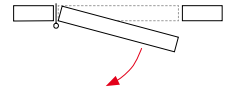

ALUMINUM MODEL

Outside materials

- blade: anodized aluminum
- adjustable cap and washers: polyamide

Inside materials

- inner axle: SST AISI 304
- inner spring: stainless steel
- blades set with protective grease

Performance

- application: suitable for indoor/ outdoor installation
- automatic return: yes
- adjustable return power: yes
- maximum door opening: 180°
- working cycles: up to 250.000

PLASTIC MODEL

Outside materials

- blade: polyamide
- adjustable cap: polyamide

Inside materials

- inner axle: polyamide
- inner spring: stainless steel
- blades set with protective grease

Performance

- application: suitable for indoor/ outdoor installation
- automatic return: yes
- adjustable return power: yes
- maximum door opening: 180°
- working cycles: up to 250.000

Proper installation

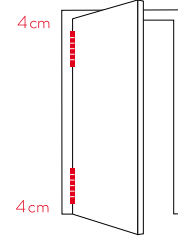

Tension

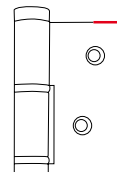
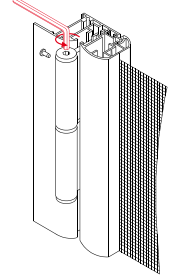

straight edge



2-points adjusting cap

MZ AL

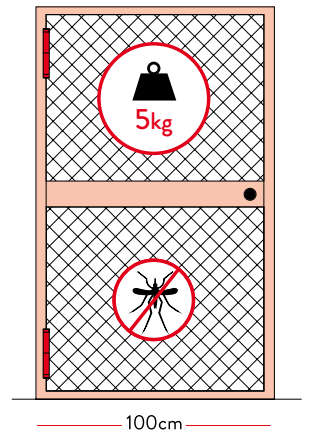
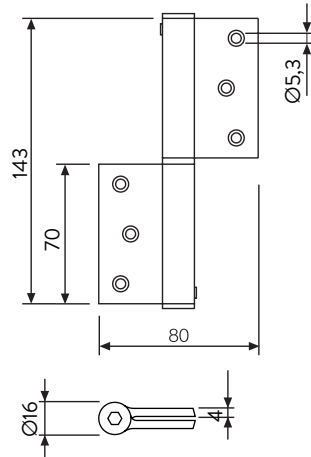
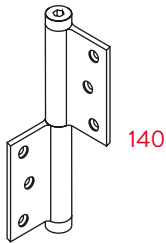

MZ PL

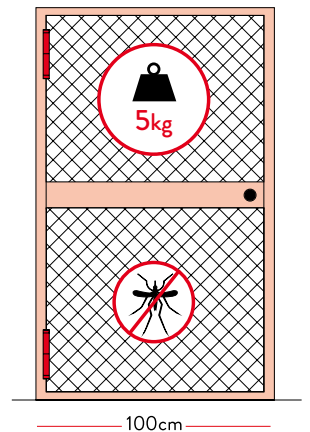
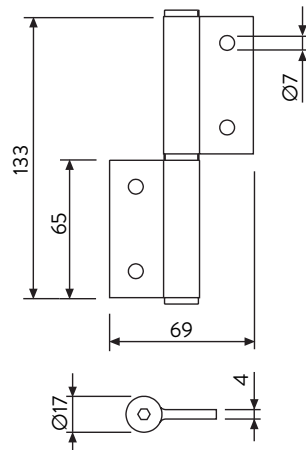
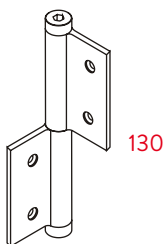

ACCESSORIES

PLASTIC MZ GUIDE

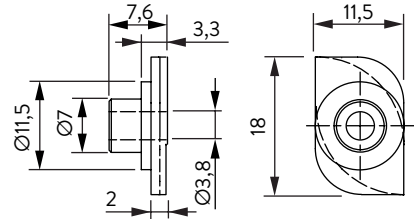
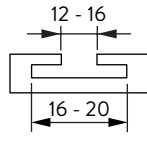
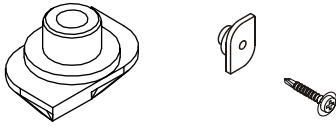

METALLIC MZ GUIDE 13x17

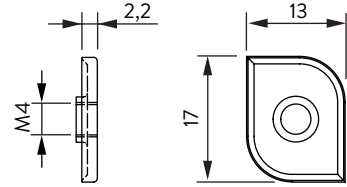
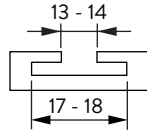
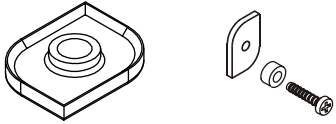

METALLIC MZ GUIDE 14x19

